

MLN-100

1 H.P. CHILLER UNIT

PROJECT NAME: _____ ITEM #: _____

APPROVED BY: _____ DATE: _____

CHILLER NOMENCLATURE:

MLN-100-HGB HA

STYLE OF CHILLER
CHILLER SIZE

LEGEND: MLN = MILLENNIUM 100 = 1 H.P.

CHILLER FRAME MADE OF 304 STAINLESS STEEL

DISCLAIMERS:

- CHILL RITE RESERVES THE RIGHT TO CHANGE MEASUREMENTS WITHOUT NOTICE.
- THIS DRAWING IS THE SOLE PROPERTY OF CHILL RITE MANUFACTURING AND SHOULD NOT BE USED OR RECREATED WITHOUT WRITTEN CONSENT FROM CHILL RITE.
- COLORATION IS A DIGITAL REPRESENTATION AND DOES NOT REFLECT THE ACTUAL COLOR

• CHILLER SPECIFICATIONS •

COMPRESSOR SIZE	1 H.P.
BTU RATING	9,199
MAX HEAT REJECTION	13,799
REFRIGERANT TYPE	R-404A
REFRIGERANT CHARGE	65 OZ
GLYCOL CIRCULATION PUMP	100 GPH
GLYCOL RESERVOIR	2 GALLONS
VOLTAGE	208/230V
FREQUENCY	60Hz
PHASE	1Ø
FULL LOAD AMPS	11 AMP
BREAKER SIZE	20 AMP
NEMA PLUG TYPE	6-20P
SHIPPING WEIGHT	175

• UNIT MUST BE PLACED IN A CONDITIONED SPACE •

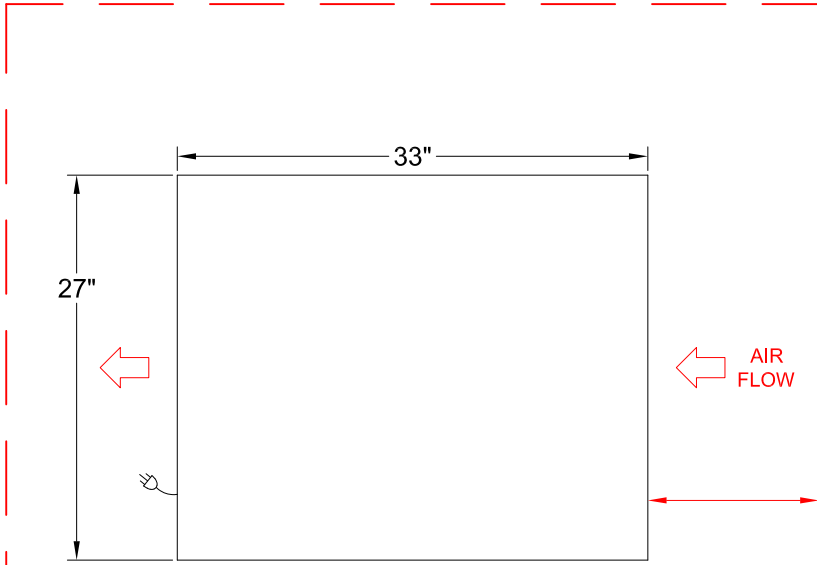

**12" MINIMUM CLEARANCE
NEEDED AROUND UNIT**

